

Rev	Modify details	Modified by/date

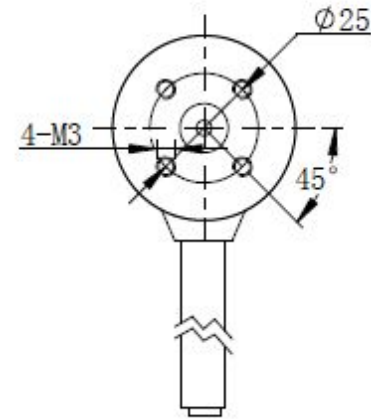
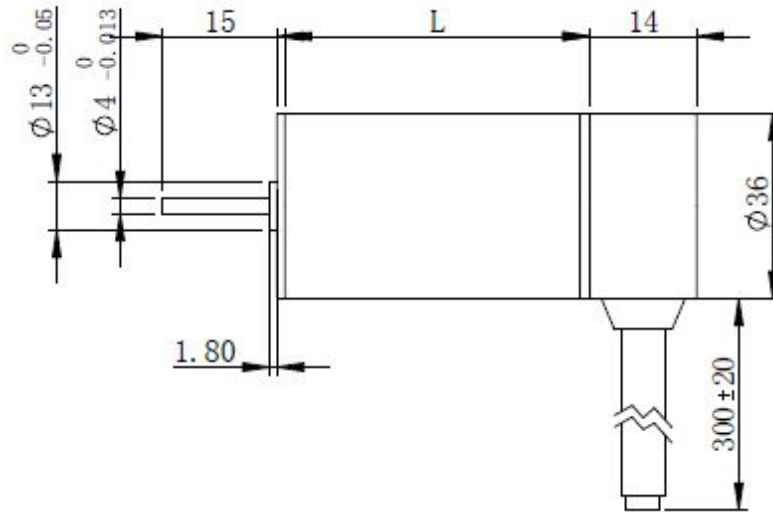

Specification:

Model		EL36RBL 40-01	EL36RBL 40-02	EL36RBL 50-01	EL36RBL 50-02	EL36RBL 60-01	EL36RBL 60-02
Number of phase		3					
Rated voltage	VDC	12	24	12	24	12	24
Rated speed	RPM	4000	5000	6000	6000	8000	8000
Rated torque	mN.m	11.76	18.62	11.76	22.54	23.52	29.4
Rotor power	W	5	10	8	15	20	25
Body length	mm	40	40	50	50	60	60
Weight	Kg	0.15	0.15	0.18	0.18	0.22	0.22

General specification:

Item	Specifications
Winding type	Star/Delta
Hall effect angle	120 degree electrical angle
Shaft run out	0.025mm
Radial play	0.06mm@450g
End play	0.08mm@450g
Max. radial force	15N@10mm from the flange
Max. axial force	10N
Insulation class	Class B
Dielectric strength	500VAC for one minute
Insulation resistance	100MΩMin.500VDC

Project No.:	Part No.:	Material	REV
	EL36RBL DC		A
Description:		Weight	Scale
DC Brushless Motor		Design:	
ELMEQ www.elmeq.com		Approve:	



This drawing and its contents are the property of ELMEQ and must not be copied, reproduced, transmitted or disclosed to any third party without written consent of ELMEQ