

Rev	Modify details	Modified by	Date
A	No load speed, No load current, Resistance, Back-emf	Tim	20210701

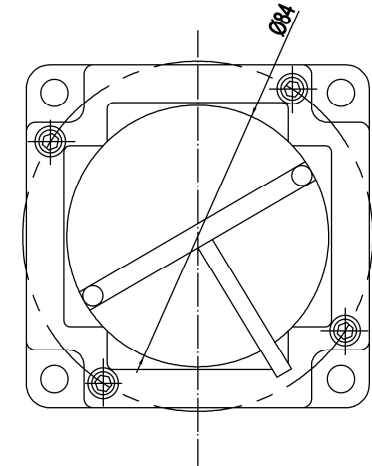
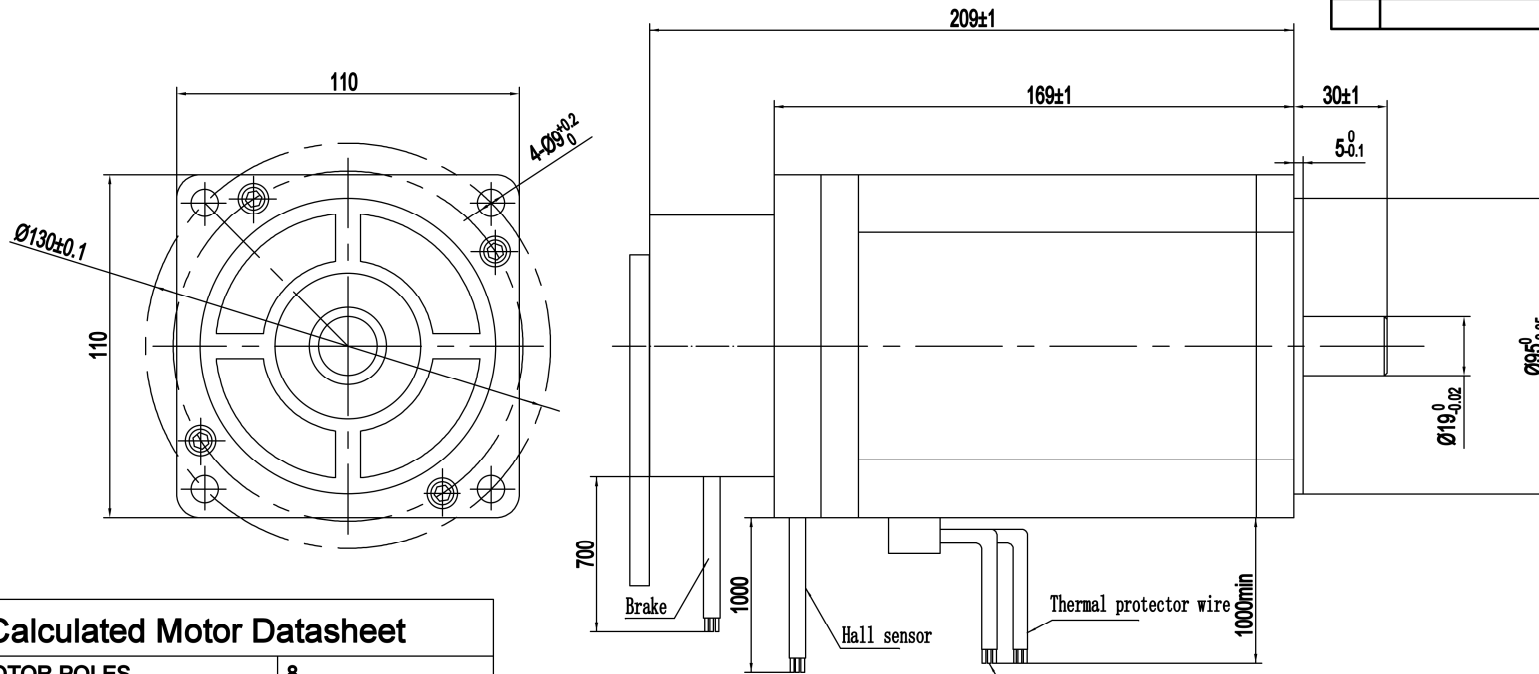

Calculated Motor Datasheet

ROTOR POLES	8
WINDING TYPE	Star winding
RESISTANCE	0.067 OHMS
NOMINAL VOLTAGE	24 VDC
NO LOAD SPEED	2100 RPM
NO LOAD CURRENT	3 Amps
RATED TORQUE	5.2 N-m
RATED CURRENT	57Amps
RATED SPEED	1450±10% RPM
OUTPUT POWER	790 W
BACK EMF CONSTANT	8.1 V/kRPM
TORQUE CONSTANT	0.09 N-m/A
INSULATION CLASS	B
DIELECTRIC STRENG	600VAC 1SEC
INSULATION RESIST	100MOhm @500VDC
ROTOR INERTIA	10.05Kg.cm ²
WEIGHT	7Kg
FRONT BEARING	NSK 6304
REAR BEARING	NSK 6202
OPERATING TEMPERATURE	-20~+50C°
STORAGE TEMPERATURE	-20~+60C°

Lead wires function define

Thermal protector	TP1	GRE	UL1330 24AWG
	TP2	GRE	
Brake	BRAKE	RED	0.5mm ²
	BRAKE	BLK	
Hall sensor	+5V	RED	Black/ Five-core shielding cable, AWG26 D=5.1mm
	HALL A	YEL	
	HALL B	GRE	
	HALL C	BLU	
Motor winding	GND	BLK	
	PHASE A	YEL	UL1330 16AWG
	PHASE B	BLK	
	PHASE C	BLU	
	PE	YEL/GRN	UL1330 16AWG

Thermal protector datasheet

Supplier part No.	TB02-BB1D-120
Work type	Normally Close
Disconnection temperature	120±5°C
Reset temperature	85±15°C

Brake datasheet

Supplier part No.	SAB0.4-24V-15-5-F
Voltage	24 VDC
Static friction torque	Min 6Nm
Resistance	Min 30ohm
Insulation grade	F
Release hand	With release hand

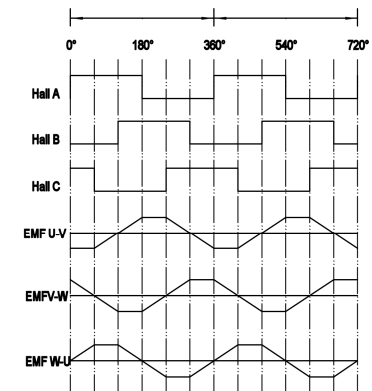

Motor front shaft CW rotate
(See from motor front shaft end)

Project No.: 80690	Part No.: EL110BLSB207-80690	Material	REV B
Description: DC Brushless motor		Weight	Scale 1:1
Design: Tim Huang 2020/07/01		Approve:	
 www.elmeq.com			



This drawing and its contents are the property of ELMEQ and must not be copied, reproduced, transmitted or disclosed to any third party without written consent of ELMEQ.